

ITEM NO.	PART NUMBER	DESCRIPTION	FINISH	WEIGHT (PER)	QTY.
1	MP1144.04	BRACE ANGLE (L2-1/2" X 2-1/2" X 1/4" X 60")	H.D.G.	20.32	3
2	MP1144.03	CORNER CLIP PLATE (F.B. 5" x 3/8" x 12")	H.D.G.	5.92	6
3	GB0516A	5/8" x 1-3/4" HEX BOLT	H.D.G.	0.26	12
4	GL05	5/8" LOCK WASHER	H.D.G.	0.03	36
5	GN05A	5/8" HEX NUT (2H)	H.D.G.	0.12	36
6	GF05	5/8" FLAT WASHER	H.D.G.	0.08	24
7	GU54440	5/8" x 4" x 2-1/2" x 2" U-BOLT	H.D.G.	0.91	12

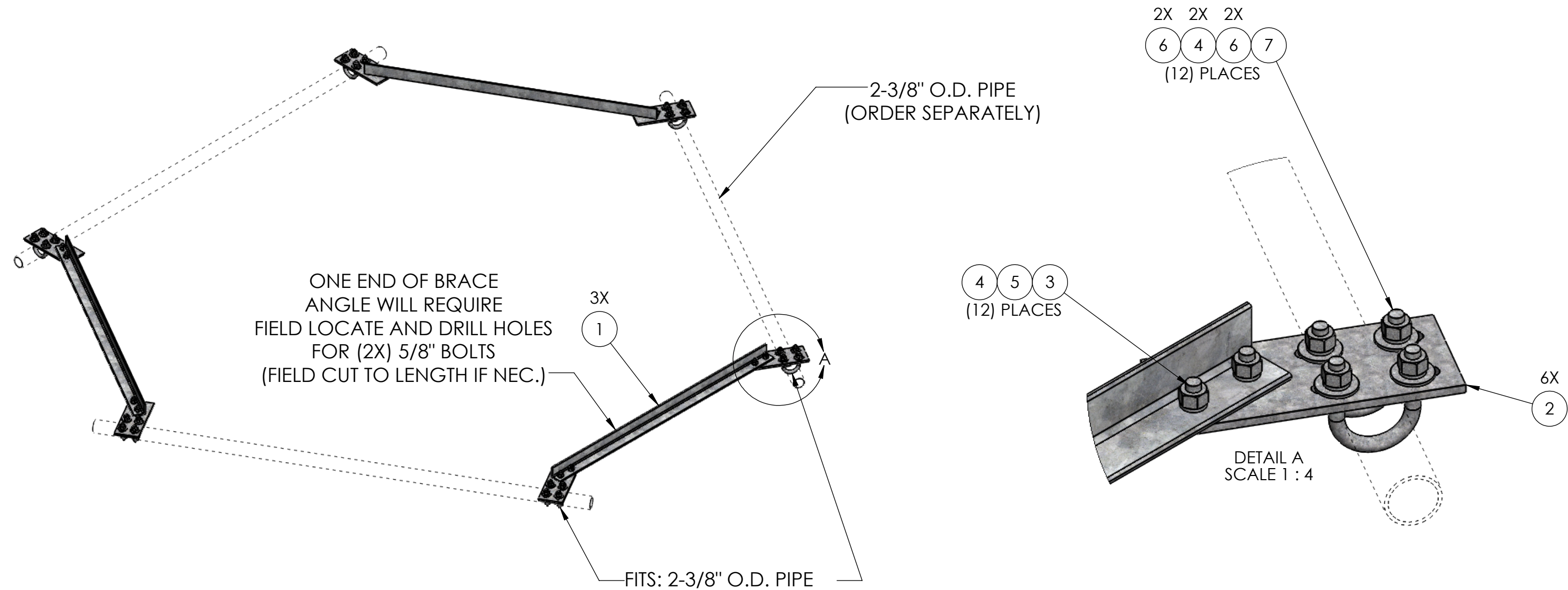

<div>UNLESS OTHERWISE SPECIFIED: DIMENSIONS ARE IN INCHES TOLERANCE ± 1/16</div>		DESCRIPTION: ANGLE CORNER SUPPORT KIT, FITS 2-3/8" PIPE		
		DWG NO: MP3502		
SIZE B		<div></div>	PRO TOWER MANUFACTURING L.L.C. 5601 San Francisco St. NE Albuquerque, N.M. 87109 (505) 924-2810	
MATERIAL -			DRAWN BY: AJK	DATE: 6/13/2022
FINISH H.D.G.			CHECKED BY: E. FILMER	DATE: 6/13/2022
			SHEET: 1 of 1	SCALE: NTS
PROPRIETARY AND CONFIDENTIAL THE INFORMATION CONTAINED IN THIS DRAWING IS THE SOLE PROPERTY OF PRO TOWER MANUFACTURING L.L.C. ANY REPRODUCTION IN PART OR AS A WHOLE WITHOUT THE WRITTEN PERMISSION OF PRO TOWER MANUFACTURING L.L.C. IS PROHIBITED.			REV	WEIGHT: 117.64