

ITEM NO.	PART NUMBER	DESCRIPTION	FINISH	WEIGHT (PER)	QTY.
1	TW1180	ANGLE CROSSOVER PLATE (KIT OF 1), 1-1/2" O.D. TO 3-1/2" O.D.	H.D.G.	3.44	1

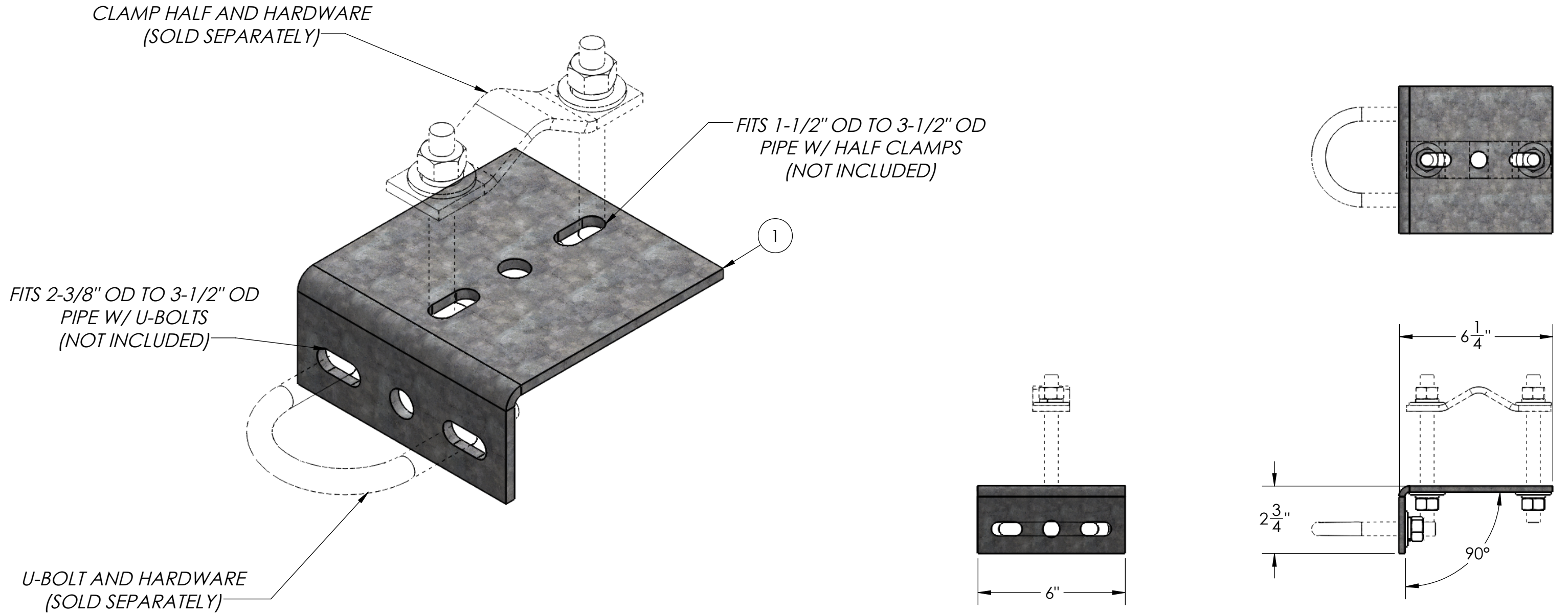

UNLESS OTHERWISE SPECIFIED: DIMENSIONS ARE IN INCHES TOLERANCE ± 1/16		DESCRIPTION: ANGLE CROSSOVER PLATE, FITS 1-1/2" OD TO 3-1/2" OD (KIT OF 1)	
MATERIAL A36		 PRO TOWER MANUFACTURING L.L.C. 5601 San Francisco St. NE Albuquerque, N.M. 87109 (505) 924-2810	DWG NO: TW1180
FINISH H.D.G.	SIZE B		DRAWN BY: A.J.K. CHECKED BY: T.SMYTHE SHEET: 1 of 1
PROPRIETARY AND CONFIDENTIAL THE INFORMATION CONTAINED IN THIS DRAWING IS THE SOLE PROPERTY OF PRO TOWER MANUFACTURING L.L.C. ANY REPRODUCTION IN PART OR AS A WHOLE WITHOUT THE WRITTEN PERMISSION OF PRO TOWER MANUFACTURING L.L.C. IS PROHIBITED.		DATE: 9/1/2021 DATE: 9/1/2021 SCALE: NTS REV WEIGHT: 3.44	