

ITEM NO.	PART NUMBER	DESCRIPTION	MATERIAL	FINISH	QTY.
1	WT1501	WELD-ON TRANSITION RING 12", FOR 42" POD	ASTM A36	H.D.G. (OPTIONAL)	1

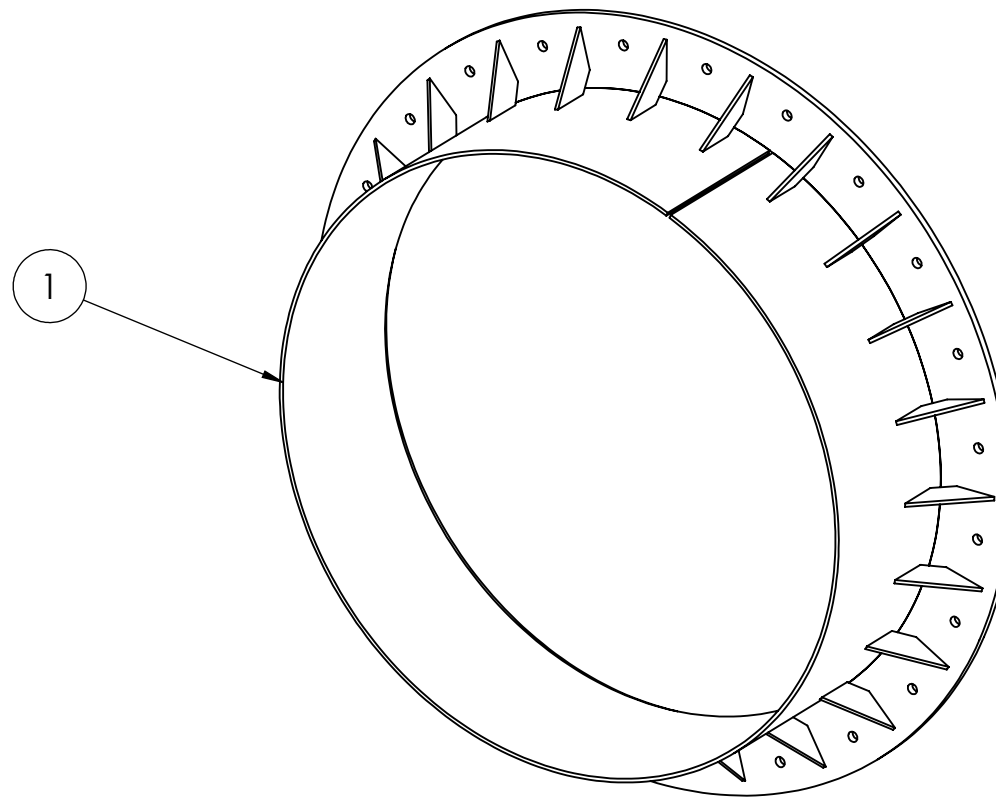
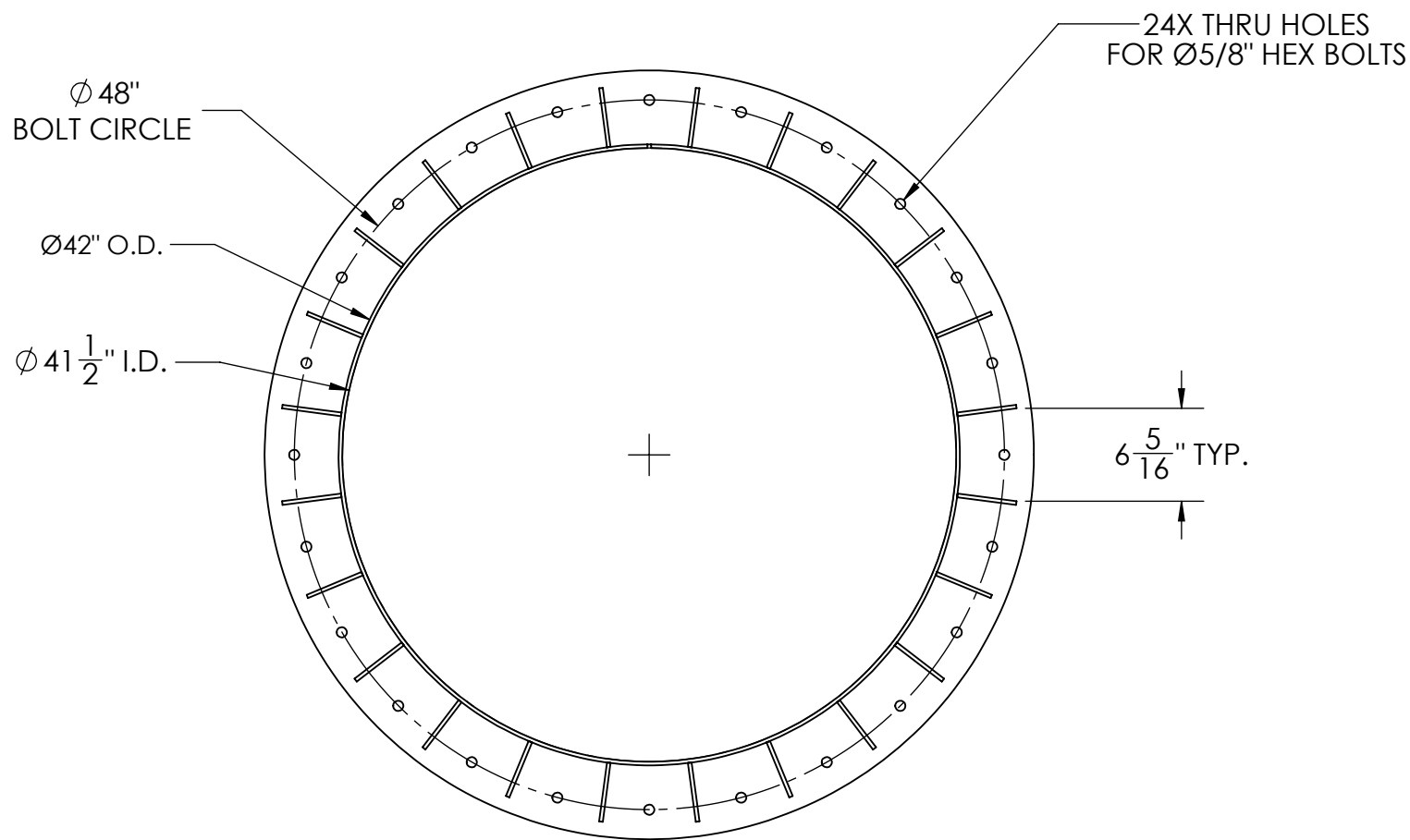
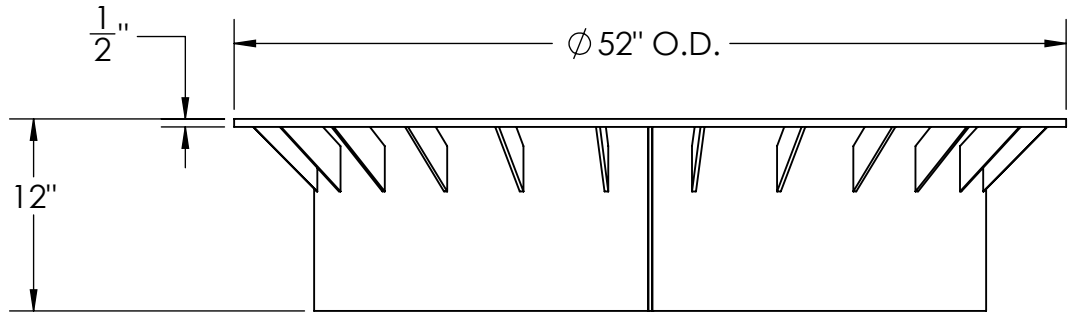

		UNLESS OTHERWISE SPECIFIED: DIMENSIONS ARE IN INCHES TOLERANCE ± 1/16	DESCRIPTION: WELD-ON TRANSITION RING 12", FOR 42" POD				
			 <b>PRO TOWER MANUFACTURING L.L.C.</b> <b>5601 San Francisco St. NE Albuquerque, N.M. 87109 (505) 924-2810</b>		DWG NO:  WT1501		
MATERIAL -	SIZE <b>B</b>	PROPRIETARY AND CONFIDENTIAL THE INFORMATION CONTAINED IN THIS DRAWING IS THE SOLE PROPERTY OF PRO TOWER MANUFACTURING L.L.C. ANY REPRODUCTION IN PART OR AS A WHOLE WITHOUT THE WRITTEN PERMISSION OF PRO TOWER MANUFACTURING L.L.C. IS PROHIBITED.			DRAWN BY: AJK		DATE: 5/6/2021
			CHECKED BY: T.SMYTHE		DATE: 5/6/2021	WEIGHT: 223.28	
FINISH H.D.G. (OPTIONAL)				SHEET: 1 of 1		SCALE: NTS	