

ITEM NO.	PART NUMBER	DESCRIPTION	FINISH	WEIGHT (PER)	QTY.
1	MP1186.01	15" CENTER CHANNEL BRACKET (WELDMENT)	H.D.G.	16.93	1
2	GP3500.054	PLAIN END GALV PIPE, 3-1/2" O.D. x 54" (4'-6")	H.D.G.	34.21	1
3	GU54574	5/8" x 7-1/2" x 4-5/8" x 2-1/2" U-BOLT	H.D.G.	1.62	2
4	GF05	5/8" FLAT WASHER	H.D.G.	0.08	4
5	GL05	5/8" LOCK WASHER	H.D.G.	0.03	4
6	GN05A	5/8" HEX NUT (2H)	H.D.G.	0.12	4
7	GU43550	1/2" x 5-1/2" x 3-5/8" x 2-1/2" U-BOLT	H.D.G.	0.77	4
8	GF04	1/2" FLAT WASHER	H.D.G.	0.04	8
9	GL04	1/2" LOCK WASHER	H.D.G.	0.02	8
10	GN04A	1/2" HEX NUT (2H)	H.D.G.	0.06	8

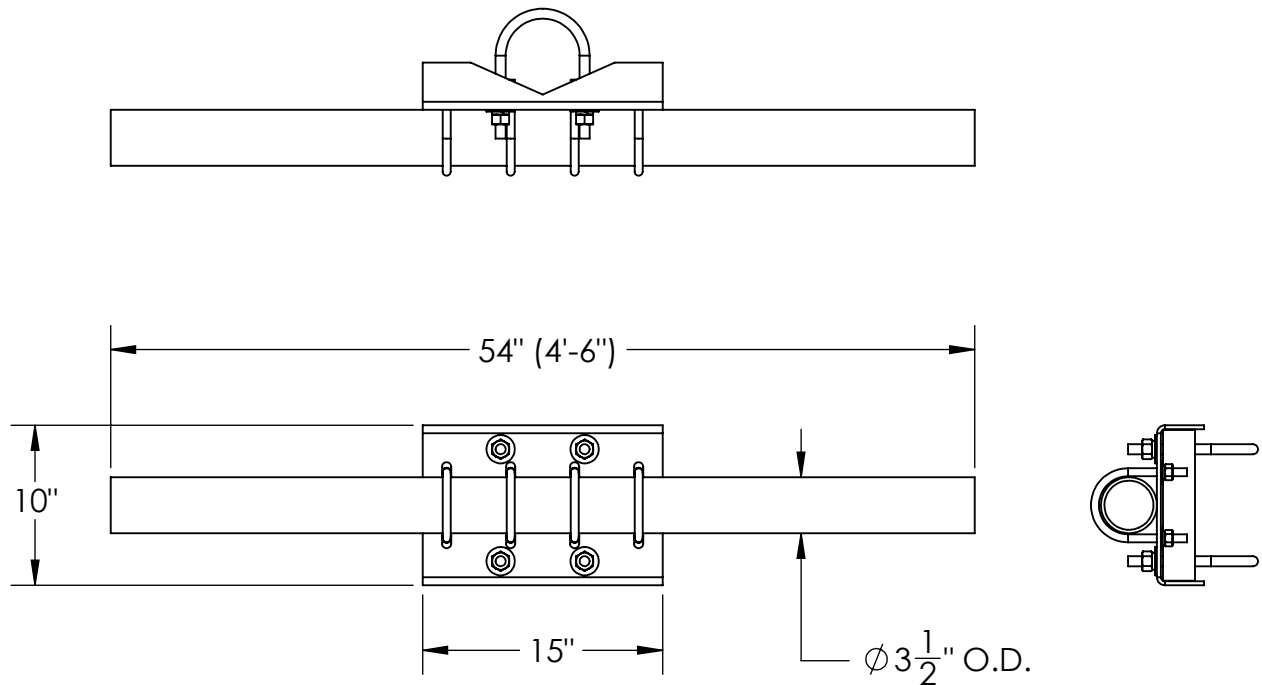
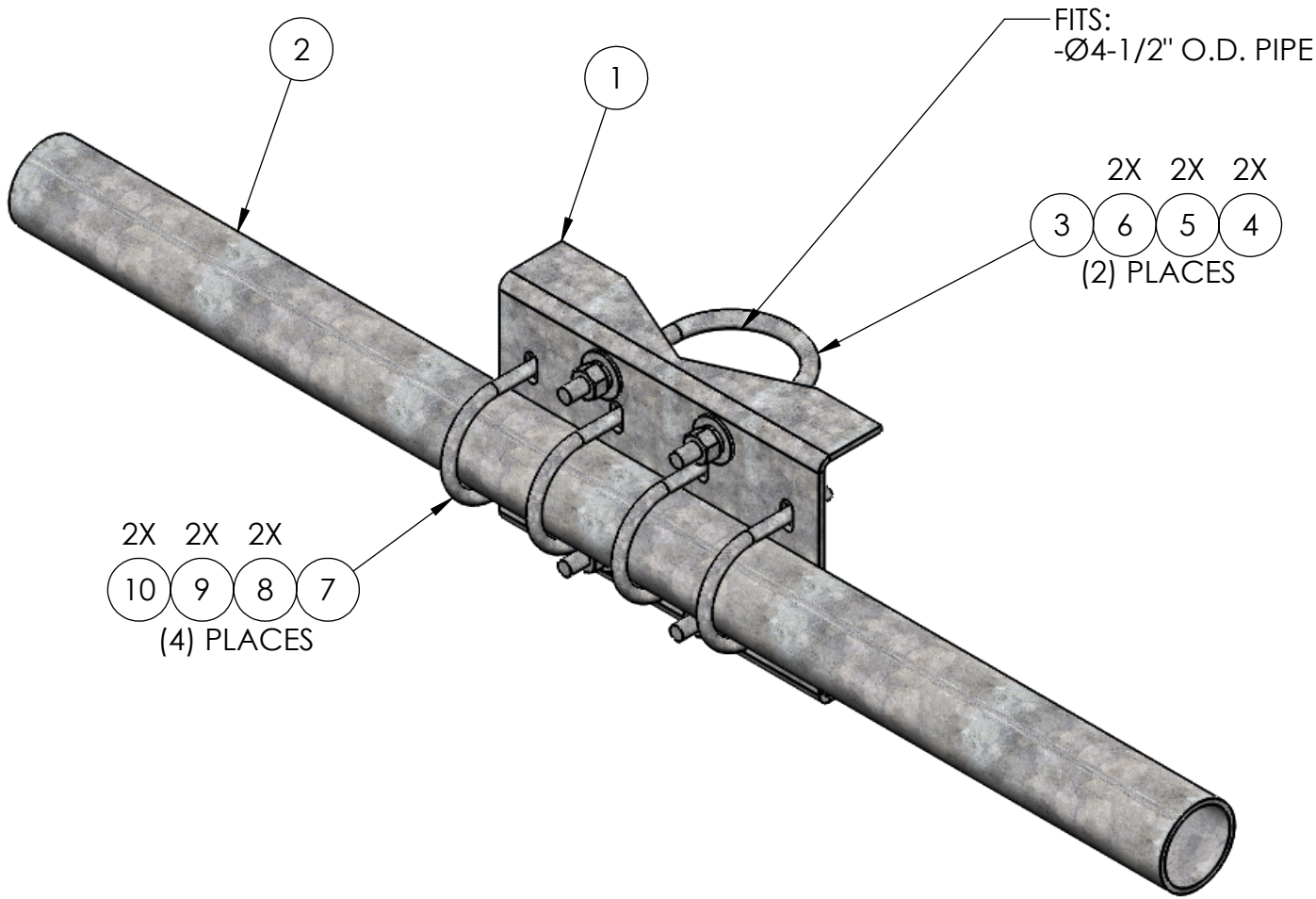

<div>MATERIAL</div> <div>FINISH</div>		<div>SIZE</div> <div>B</div>	UNLESS OTHERWISE SPECIFIED:  DIMENSIONS ARE IN INCHES TOLERANCE ± 1/16	DESCRIPTION:  MONOPOLE T-FRAME, 4'-6"		
			<div>PROPRIETARY AND CONFIDENTIAL</div> <div>THE INFORMATION CONTAINED IN THIS DRAWING IS THE SOLE PROPERTY OF PRO TOWER MANUFACTURING L.L.C. ANY REPRODUCTION IN PART OR AS A WHOLE WITHOUT THE WRITTEN PERMISSION OF PRO TOWER MANUFACTURING L.L.C. IS PROHIBITED.</div>	<div></div> <div><div>PRO TOWER MANUFACTURING L.L.C.</div><div>5601 San Francisco St. NE</div><div>Albuquerque, N.M. 87109</div><div>(505) 924-2810</div></div>	DWG NO:  MP1155	
<div>DRAWN BY:</div> <div>AJK</div>		<div>DATE:</div> <div>9/13/2022</div>			<div>REV</div>	
<div>CHECKED BY:</div> <div>E.FILMER</div>		<div>DATE:</div> <div>9/13/2022</div>				<div>WEIGHT:</div>
<div>H.D.G.</div>					<div>SHEET:</div> <div>1 of 1</div>	<div>SCALE:</div> <div>NTS</div>